

PRODUCT INFORMATION PACKET

Model No: 5KH33JNA511T
Catalog No: HG710
1/2,1725,DP,48Z,1/60/115
Open Drip Proof (ODP)



Regal and Marathon are trademarks of Regal Beloit Corporation or one of its affiliated companies.
©2018 Regal Beloit Corporation, All Rights Reserved. MC017097E



Nameplate Specifications

| | | | |
|------------------------|-------------------|----------------------------|-------------------|
| Output HP | 1/2 Hp | Output KW | 0.37 kW |
| Frequency | 60 Hz | Voltage | 115 V |
| Current | 7.9 A | Speed | 1725 rpm |
| Service Factor | 1 | Phase | 1 |
| Efficiency | 0 % | Duty | Continous |
| Insulation Class | B | KVA Code | N |
| Frame | 48Z | Enclosure | Drip Proof |
| Overload Protector | AUTO | Ambient Temperature | 40 °C |
| Drive End Bearing Size | 6203 | Opp Drive End Bearing Size | 6203 |
| UL | Recognized | CSA | Yes |
| CE | N | | |

Technical Specifications

| | | | |
|-------------------|-----------------------|-----------------------|-----------------------------------|
| Electrical Type | Split Phase | Starting Method | SM |
| Poles | 4 | Rotation | Counterclockwise/Clockwise |
| Mounting | Resilient Base | Motor Orientation | ANY |
| Drive End Bearing | BALL | Opp Drive End Bearing | BALL |
| Frame Material | Rolled Steel | Overall Length | 9.93 in |
| Frame Length | 5.41 in | Shaft Diameter | 0.5 in |
| Shaft Extension | 2.25 in | | |
| Outline Drawing | 52A106661P5 | Connection Diagram | 52A105379AA |

This is an uncontrolled document once printed or downloaded and is subject to change without notice. Date Created: 10/08/2018

THIRD ANGLE PROJECTION



REVISIONS

| REV. | DESCRIPTION | DATE | APPROVED |
|------|---------------------------------|----------|-----------|
| 5 | ADDED PT#5, UPDATED SHELL VENTS | 01/14/94 | M.D. PAPE |
| 6 | ADDED PART #6. | 11/09/95 | M.D. PAPE |
| 7 | CHG TO RBC FORMAT PER IS05-1777 | 02/13/06 | SUDHA |

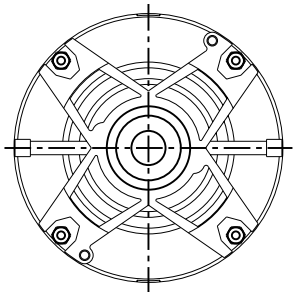

VIEW SHOWING P.E. VENTILATION OPENINGS

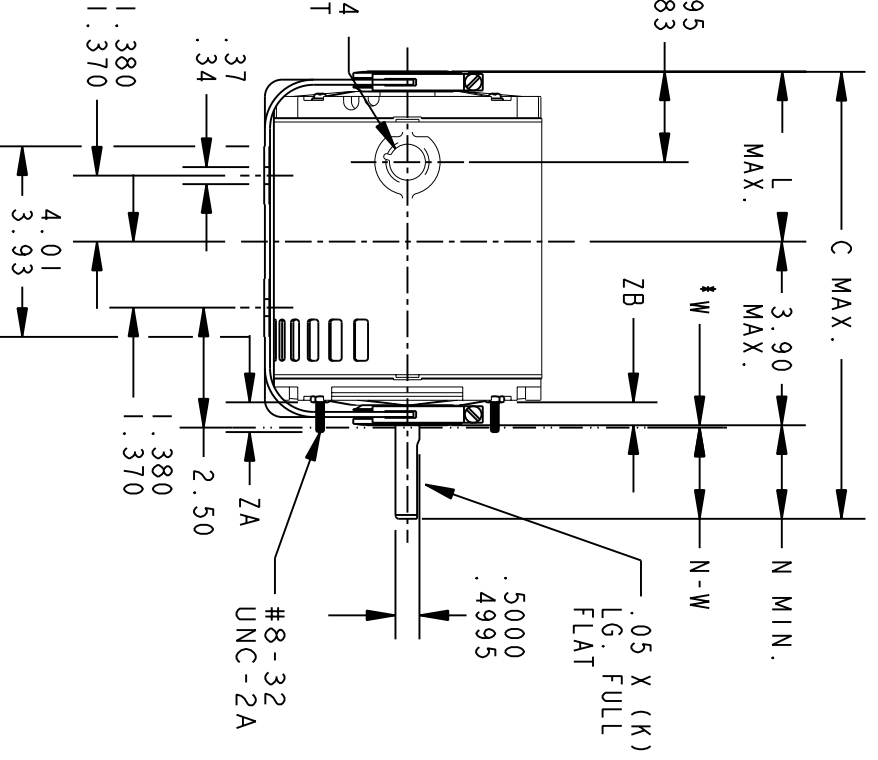
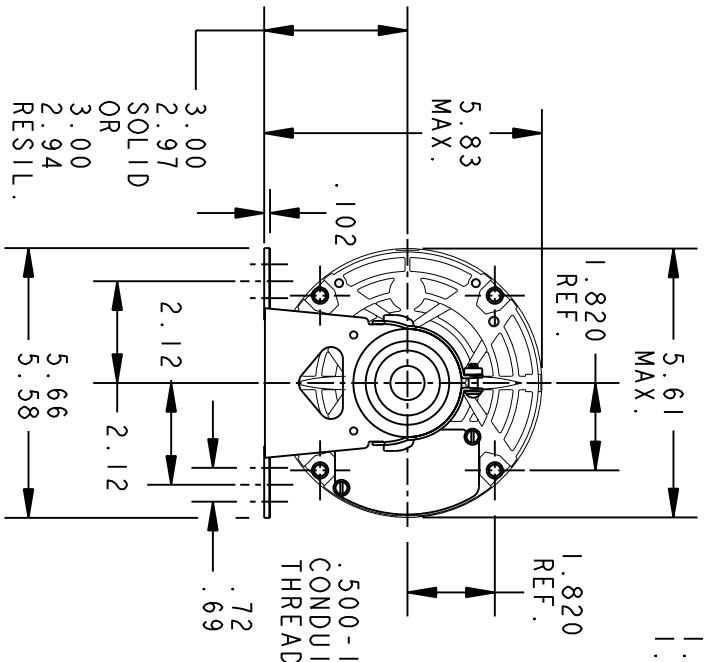

| P | TYPE | GE SIZE | NEMA FR | C | K | L | N | N-W | ZB | ZA |
|---|------|---------|---------|------|------|------|------|-----------|---------|-----|
| 6 | KH | 35 | 48 | 9.56 | 1.16 | 4.22 | 1.50 | 1.63/1.41 | .55/.52 | .50 |
| 5 | KH | 33 | 48Z | 9.93 | 1.91 | 3.84 | 2.25 | 2.38/2.16 | .55/.52 | .90 |
| 4 | KH | 32 | 48 | 8.93 | 1.16 | 3.59 | 1.50 | 1.63/1.41 | .55/.52 | .62 |
| 3 | KH | 36 | 48 | 9.99 | 1.16 | 4.65 | 1.50 | 1.63/1.41 | .55/.52 | .50 |
| 2 | KH | 32 | 48Z | 9.94 | 1.91 | 3.59 | 2.25 | 2.38/2.16 | .55/.52 | .62 |
| 1 | KH | 32 | 48Z | 9.32 | 1.54 | 3.59 | 1.88 | 2.01/1.79 | .55/.52 | .62 |

W# IS A CLEARANCE DUE TO VARIATION IN PARTS AND ASSEMBLY.

SIGNATURES DATE

MODEL D.A.BAESKE 07/05/88

DETAIL

CHECKED

ENGRG

MFG

QUALITY

ISSUED B.L.J. 06/04/92

SOLID MODEL: 52A106661

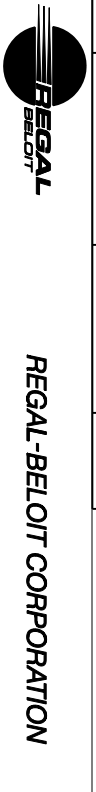

TITLE OUTLINE

FORM N - GENERAL PURPOSE MOTOR - DRIP PROOF - SOLID OR RESIL. BASE - BALL OR SLEEVE BEARING

SCALE: 0.250 REF. No.: 52A106661 REV 7

SHEET 1 of 1

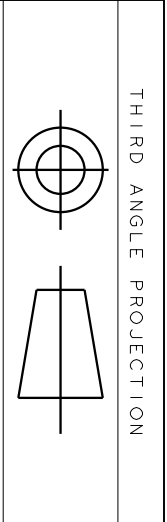

| REV. | DESCRIPTION | DATE | APPROVED |
|------|----------------|----------|----------|
| 6 | UPDATED FORMAT | 12/01/05 | MAM |

EITHER ROTATION-SINGLE VOLTAGE-TYPE KC OR KH-WITH THERMAL PROTECTOR

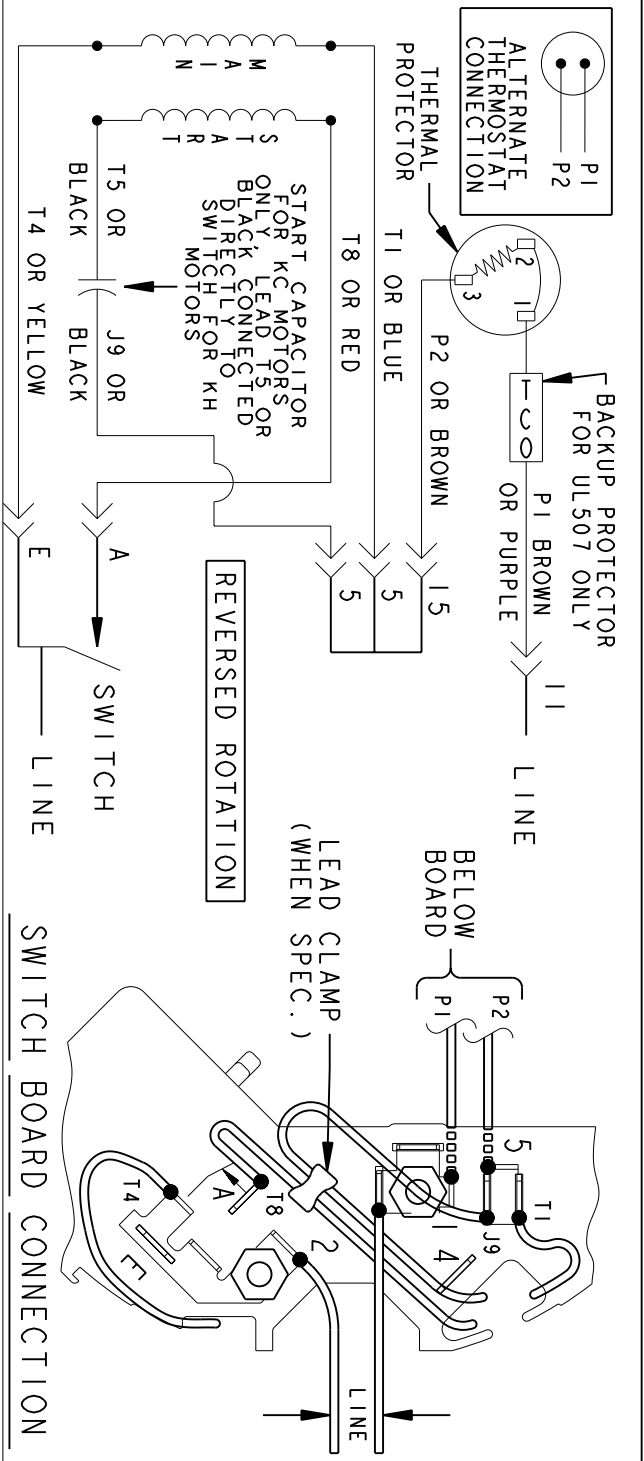
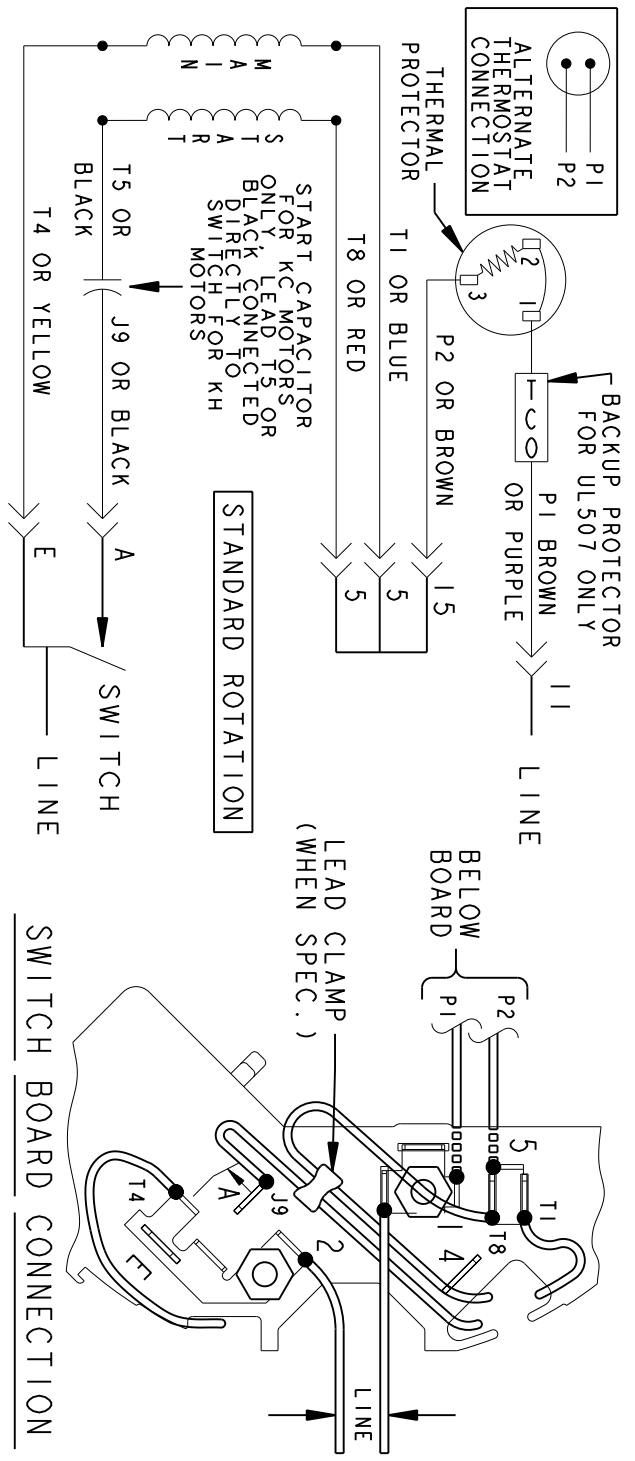

NOTE #1 - TO REVERSE ROTATION INTERCHANGE RED (T8) AND BLACK (J9-KC OR T5-KH) LEADS.
 NOTE #2 - WHEN MORE THAN ONE CAPACITOR IS USED CONNECT IN PARALLEL.

SWITCH (C) - 115D958AB REF. DIAG. - 121A851 CONN. LABEL - 52X332048

| SIGNATURES | DATE |
|--------------------------|------------------|
| MODEL M.D. PAPE | 06/29/87 |
| DETAIL | |
| CHECKED | |
| ENGRG | |
| MFG | |
| QUALITY | |
| ISSUED | M.D. P. 03/08/00 |
| SOLID MODEL: 52A105379AA | |

REGAL-BELOIT CORPORATION

REGAL-BELOIT

TITLE: **CONNECTION DIAGRAM**

SIZE: DRAWING A

SCALE: 1.000 REF. No.:

30 FR SWITCH REDESIGN

52A105379AA

REV 6